

# 2019 Lift Station Elimination Near PortSA Project, CO-00592

Orlando Cruz, P.E.  
Project Engineer, SAWS

Janie M. Powell  
Contract Administrator

Tracy M. Burns  
SMWVB Program Specialist

Reddy Kajuluri, PE, CFM  
Design Consultant

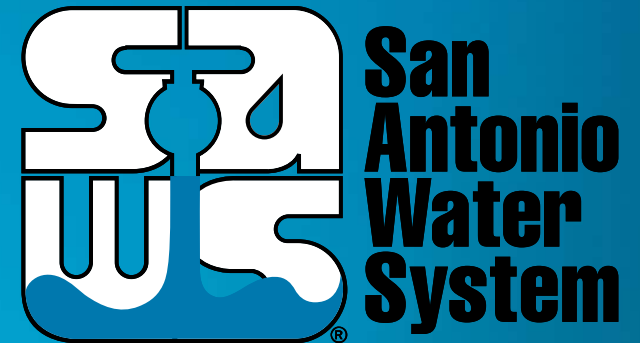

Non- Mandatory WebEx Pre-Bid Meeting  
September 6, 2022

MAKING SAN ANTONIO  
**WATERFUL**



# WebEx Reminders

- Stay muted during the entire presentation.
- Sign-In using the chat
  - Name, Company, Email Address
- Ask questions at any time during the presentation utilizing the Chat. Questions will be addressed at the end of the presentation.
  - Ensure to direct your questions to the entire group by selecting everyone from the drop down.
  - All formal responses to questions will be provided via an Addendum.
- Audio only attendees may follow along on the presentation posted to the SAWWS solicitation website.

## Oral Statements

Oral statements or discussion during the pre-bid meeting today will not be binding, nor will it change or affect the terms or conditions within the Plans and Specifications of this Project. Changes, if any, will be addressed in writing only via an Addendum.

# Agenda

- General Information
- SMWB Requirements
- Contract Solicitation Website
- Vendor Registration & Notification (VRN)
- Solicitation Schedule
- Contract Requirements
- Bid Packet Preparation
- Bid Opening Procedures
- Addenda
- Key Reminders
- Contact Information
- Project Background
- Project Overview
- Technical Specifications
- Questions

## General Information

- This is a non-mandatory pre-bid meeting
- This presentation has been posted and the attendance sheet will be posted at the end of this meeting, to the SAWS website
- Construction services being procured through low bid under Chapter 2269 of the Texas Government Code
- Geotechnical Reports are available on the SAWS website and accessible once an electronic disclaimer form is signed
- Key Project Information:
  - Construction Estimate: \$2,800,000.00
  - Calendar Duration: 402 days

# Aspirational SMWB Goal

Industry	Aspirational SMWB Goal
Construction	20%

The aspirational SMWB goal is 20% of your total bid price

2019 Lift Station Elimination Near PortSA Project



## Minimum Qualifications for SMWB recognition:

- South Central Texas Regional Certification Agency
  - Must be SBE-Certified (including MBEs and WBEs)
  - Texas Historically Underutilized Business “HUB” Program
- Local Office or Local Equipment Yard
  - Atascosa, Bandera, Bexar, Comal, Frio, Guadalupe, Kendall, Kerr, McMullen, Medina, Uvalde and Wilson counties

2019 Lift Station Elimination Near PortSA Project



# Good Faith Effort Plan (GFEP) FAQs

- **Q: Is the 20% SMWB goal mandatory?**

A: No, but we ask prime contractors to do their best with good faith outreach efforts. If the goal is not met, proof of outreach efforts is required with the submittal.

- **Q: What if I am having trouble finding SMWB subcontractors?**

A: The SCTRCA has a search portal at [www.sctrca.sctrca.org](http://www.sctrca.sctrca.org). Please make sure to include SAWWS-specific parameters in your search. Contact Marisol Robles at [Marisol.Robles@saws.org](mailto:Marisol.Robles@saws.org) if assistance is needed.

- **Q: What if my business is SMWB-certified? Do I need to find SMWB subs?**

A: If your firm is SMWB-certified, you will most likely meet the goal. However, the GFEP is a required document, and a good faith outreach effort is still necessary.

- **Q: Do I need to include all my subcontractors in the GFEP or just those that qualify towards the SMWB goal?**

A: All subcontractors need to be included in the GFEP, even those that may not count towards the SMWB goal.

- **Q: What if I have questions about the GFEP?**

A: Please contact the SMWB Program Manager at 210-233-3420, or at [Marisol.Robles@saws.org](mailto:Marisol.Robles@saws.org). GFEP questions can be asked at any time before the submittal is due.



# Post Award: Subcontractor Payment & Utilization Reporting (S.P.U.R.) System

- 1. Subcontractor & Supplier Payment Tracking
- 2. Subcontractor and Supplier Additions or Substitutions
- 3. Must be Current and Accurate before Retainage is released

<https://saws.smwbe.com>



2019 Lift Station Elimination Near PortSA Project



# Contract Solicitations Website

- To locate the Contract Solicitations, go to the SAWS website at [www.saws.org](http://www.saws.org), click on the drop-down menu for Resources and select Business Center

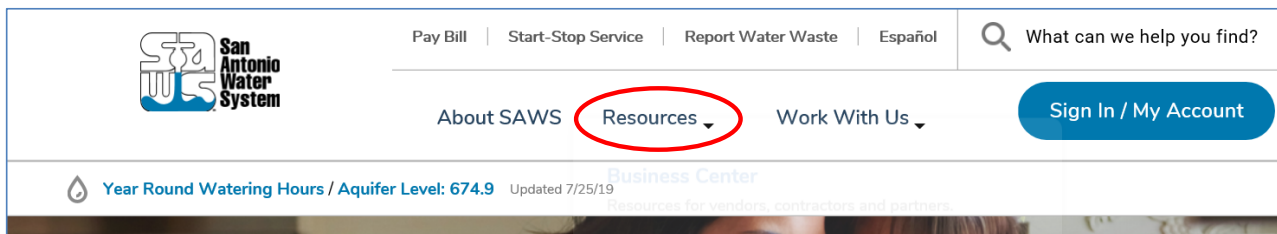

- At the left-hand menu choose Contract Solicitations

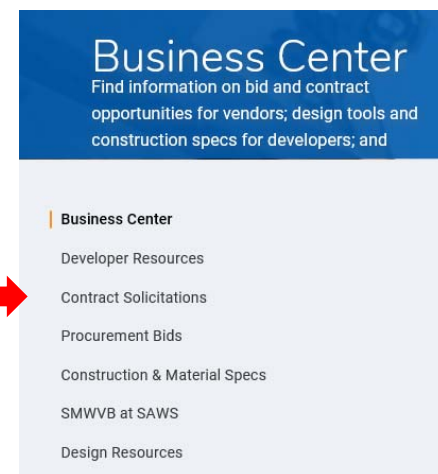

# Contract Solicitations Website

- Choose the specific project
- The following buttons are located under the advertisement:

- \*Notify Me - Subscribe
- Plan Holder’s List – View List
- Downloads
  - Specifications
  - Plans
  - Addendums
  - Engineering Reports



The screenshot displays a project advertisement for a "Non-Mandatory Pre-Bid Meeting" on August 6, 2019, at 10:00 AM. The meeting location is the San Antonio Water System Customer Service Building. Below the advertisement are three main interactive buttons: "Notify Me" (with a megaphone icon), "Plan Holders List" (with a group of people icon), and "Downloads" (with a document icon). The "Notify Me" button includes a "Subscribe" sub-button. The "Downloads" section lists "Specifications" and "Plans" for July 31, 2019, with a note that users must be logged in to access these documents. A red arrow from the text on the left points to the "Notify Me" button area.

\* To receive updates on specific projects, registered vendors must 'Subscribe' to the project by selecting the project, and clicking 'Subscribe' under the Notify Me box

## 2019 Lift Station Elimination Near PortSA Project



# Vendor Registration & Notification (VRN)

- Please register through SAWS Vendor Registration Program on the SAWS website at [Business Center - San Antonio Water System \(saws.org\)](https://www.saws.org) to ensure access to the latest information.

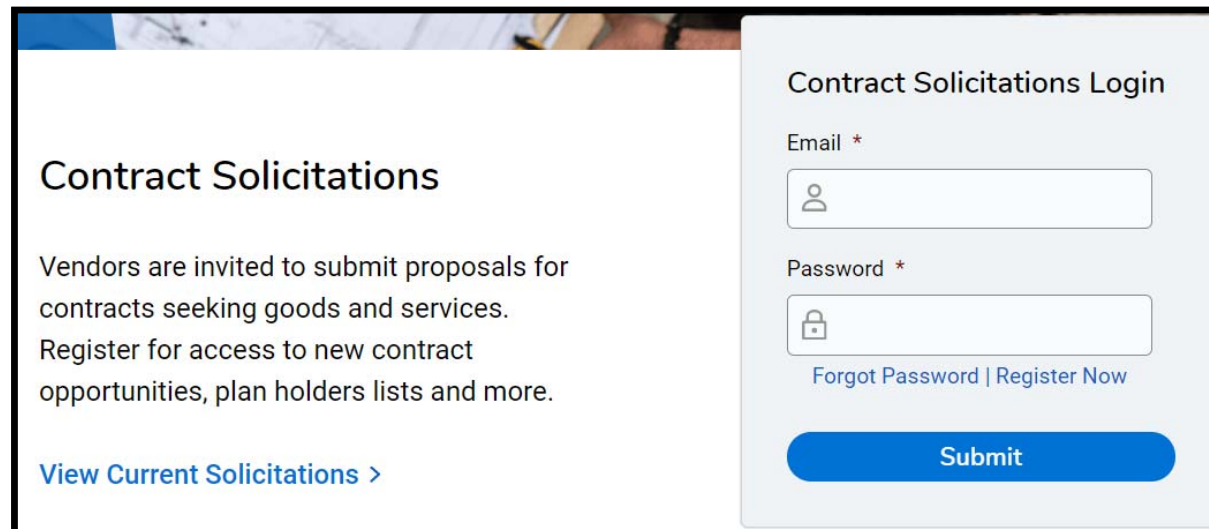

**Contract Solicitations**

Vendors are invited to submit proposals for contracts seeking goods and services. Register for access to new contract opportunities, plan holders lists and more.

[View Current Solicitations >](#)

**Contract Solicitations Login**

Email \*

Password \*

[Forgot Password | Register Now](#)

**Submit**

# Solicitation Schedule

MILESTONE	DATE / TIME
Questions Due	September 12, 2022 at 4:00 PM CDT
Answers Posted	September 19, 2022 at 5:00 PM CDT
FTP Request Deadline	September 23, 2022 at 10:00 AM CDT
Bids Due	September 26, 2022 at 10:00 AM CDT
Lowest Responsible Bidder Notified	September 26, 2022
Board Award	November 1, 2022
Estimated NTP	November 15, 2022

2019 Lift Station Elimination Near PortSA Project



# Contract Requirements

## Prevailing Wage Rate and Labor Standards – Section 2.10 of the General Conditions

- Wage decisions are included within the specifications
- Contractors to utilize LCP Tracker
- Certified payroll to be submitted on weekly basis beginning on the start date indicated on the Notice to Proceed
- Contractors are responsible for sub-contractor payroll
- Late payrolls delay contractor payments, as well as release of retainage at the end of the project
- Payroll records are subject to review
- Site visits are random and unannounced
- Interviews will be conducted and will be private & confidential
- All apprenticeship programs will need to be approved by Department of Labor prior to starting

# Contract Requirements

- Insurance requirements are found in Section 5.7 of the GCs Supplemental Conditions
  - **Pollution, Installation Floater** is required in lieu of Builder's Risk
- Selected contractor's insurance must be compliant with all other contracts
- SAWS will request insurance certificate prior to Board award to ensure insurance compliance and to assist in expediting execution of the contract
- Selected contractor must ensure insurance is compliant for the duration of the contract

# Contract Requirements

## Supplemental Conditions (Continued)

- Contractor shall perform the work with its own organization on at least 40% of the total original contract price which should be indicated on the Good Faith Effort Plan.

Type/s of Certification: SBE: \_\_\_\_\_ MBE: \_\_\_\_\_ VBE: \_\_\_\_\_ WBE: \_\_\_\_\_

Prime Contractor's Percentage of Participation: (Ex: 100% is the total value of the contract.) \_\_\_\_\_ %

Describe your firm's participation to be performed on this Project: \_\_\_\_\_

- Liquidated damages will be assessed at \$965.00 per day



# Bid Packet Preparation

- Only limited items are required with the initial bid packet
  - List of Bid Items
  - Bid Packet Checklist
  - Signed Bid Proposal Signature Page with
    - Acknowledgement of all Addenda
    - Executive Order
  - Signed Proposal Certification
  - Bid Bond
  - Good Faith Effort Plan

# Contract Requirements

## Apparent Low Bidder

- Notified by SAWS within 24 hours of Bid Opening to provide the following within one (1) business day
  - Conflict of Interest Questionnaire - Form CIQ (Rev. 1/1/2021)
  - Proof of Insurability
  - Company Information Packet
  - Statement regarding ability to complete the project
  - W-9
  - Detailed Baseline Schedule
  - Statement of Bidder's Experience
- \*And, if bid was submitted electronically without a Bid Bond:
  - Cashier's Check or Certified Check

# Contract Requirements

## Apparent Low Bidder (Continued)

- To provide the following within one (1) business day
  - Statement of Bidder’s Experience Form
    - Record of performance on three (3) distinct projects
    - Demonstrates construction of a minimum of 1,000 LF of 12 inch (or larger) sanitary sewer main by Open Cut Method completed by the Bidder
    - Demonstrates construction of Sanitary Sewer Lift Station completed by Bidder or Sub
    - Demonstrates demolition of existing Sanitary Sewer Lift Station completed by Bidder or Sub
    - Projects must have been completed between 2016 and 2022
    - Ensure all project reference contact information provided is current and valid prior to submitting
  - Detailed Baseline Schedule
    - Estimated notice to proceed date of November 15, 2022

2019 Lift Station Elimination Near PortSA Project



# Bid Packet Preparation

- Utilize the Bid Packet Checklist within the specifications
- Double check all mathematical calculations and verify all extensions
- Addendums are acknowledged on the Bid Proposals
  - Check the SAWS website regularly for addendum postings
  - It is possible to have multiple addendums

## Bid Packet Preparation

- Pay close attention to the Mobilization and Preparation of ROW line items on the Bid Proposal as they are broken down by site/location
- Bidders must also provide the combined cost of the sites/locations and enter a subtotal for Mobilization and Preparation of ROW (all sites combined)
- Ensure Mobilization & Prep ROW do not exceed the percentages allowed once subtotaled
- When preparing the bid tab, SAWS will verify both the subtotals and total of site/location line items. If there is a discrepancy the subtotal provided by the Bidder will take precedence to correct the bid.

# Bid Opening Procedures

- Bids will be submitted using SAWS' electronic bid opening procedures
- SAWS encourages and prefers the submission of electronic bids using its secure FTP site.
  - Bidders should submit a request via email to obtain access to the site no later than 24 hours before the bid opening.
- Or, Bidders may drop off a hard copy bid. Only required items.
  - Drop box is located at 2800 US Hwy 281 N, Customer Service Tower
    - Enter the first set of glass double doors
    - Insert into the black drop box on the wall on the left-hand side
- Late bids will not be accepted and will be returned unopened.
- Bid Opening will be handled via WebEx only; link found in IFB

# Addenda

- Known Addenda will include:
  - Response to questions

2019 Lift Station Elimination Near PortSA Project



## Key Reminders

- All questions should be sent in writing to the corresponding Contract Administrator by email [Janie.Powell@saws.org](mailto:Janie.Powell@saws.org) or fax, 210-233-5351.
- Please identify the project by its associated solicitation number. (CO-00592)



# Contact Information

<u>Contact Name</u>	<u>Title</u>	<u>Telephone Number</u>	<u>Email address</u>
Janie M. Powell	Contract Administrator	210-233-2443	<a href="mailto:Janie.Powell@saws.org">Janie.Powell@saws.org</a>
Marisol V. Robles	SMWVB Program Manager	210-233-3420	<a href="mailto:Marisol.Robles@saws.org">Marisol.Robles@saws.org</a>

## REMINDER

Please be advised that Bidders are prohibited from communicating with any other SAWS staff, the Consultant, the Developer, or City of San Antonio officials regarding this IFB up until the contract is awarded as outlined in the Instructions to Bidders

# Project Background

## 9 Project Locations

➤ LS 105, 260, 305, 307, 310, 320, 326, 329, 333.

➤ Approx. 175 LF of 8-inch, 2,259 LF of 12-inch, 380 LF of 2-inch sanitary sewer line by OpenCut.

➤ Demolition of 9 Lift Stations.

➤ One New Lift station - 105.

➤ Access to Secured areas

➤ Port of SA

➤ JBSA-Lackland

➤ Boeing Facility

➤ Standard Aero Facility

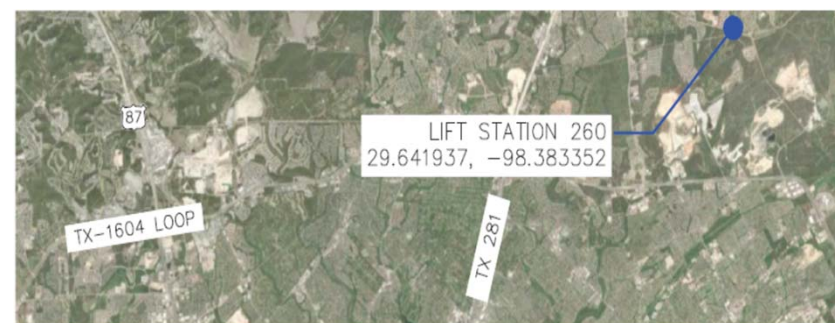
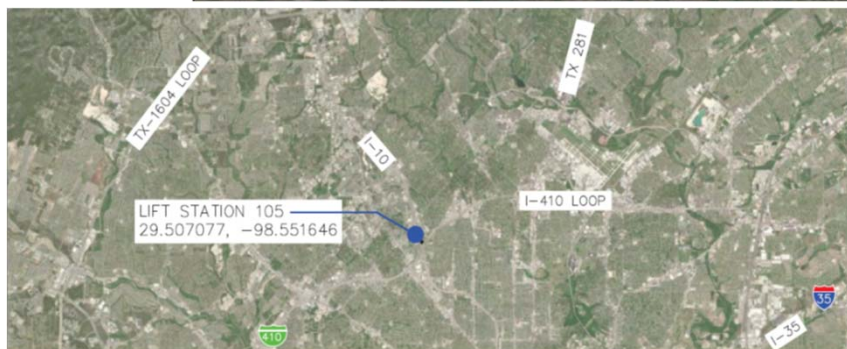
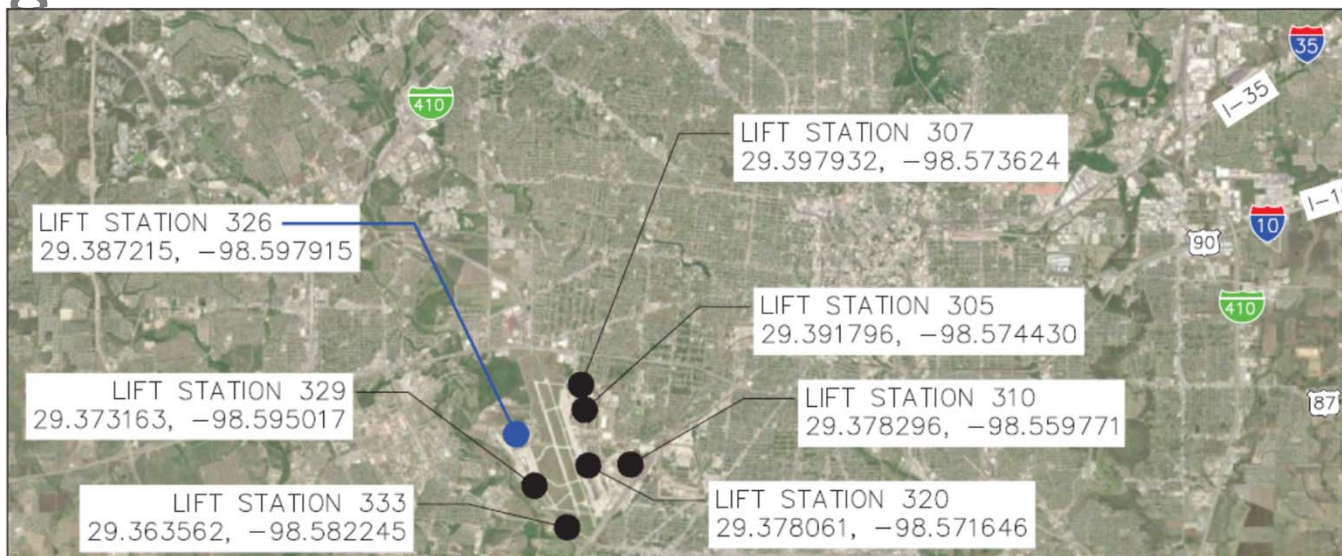

## 2019 Lift Station Elimination Near PortSA Project



# Project Overview

## Special Conditions

### ➤ Project Data:

Construction Period: 402 days.

### ➤ Schedule:

Site work at LS 326 and 329 to be prioritized.

### ➤ Permits:

Contractor to begin coordination immediately after Notice to Proceed is provided by SAWS to avoid construction delay in obtaining site access and permits.

### JBSA-Lackland Permits

Special clearance considerations for LS #326, 320 & 329 include arranging for an escort during construction and other restrictions.

### Port of SA Permits

Contractor to coordinate with the Port of SA to obtain dig permits for each lift station site.

2019 Lift Station Elimination Near PortSA Project



# Project Overview

## Special Conditions

### ➤ CPS Energy Allowance:

Contractor to begin coordination immediately after Notice to Proceed is provided by SAWS to avoid construction delay. Contractor to coordinate with CPS Energy and provide all labor, supervision, tools, equipment, and materials necessary to brace and/or relocate power poles, guy wires as required to complete work. Payment for utility pole bracing/service relocation will be made from the allowance included in the bid.

### ➤ Tree Protection:

SAWS will provide Tree permit to the Contractor. Contractor is advised to proceed with caution when working near these areas and coordinate with CoSA Arborist as required.

### ➤ CoSA Coordination:

Contractor shall obtain ROW permit and conform to CoSA permit requirements while performing construction activities.

# Project Overview

## Special Conditions

### ➤ Subsurface Utility Investigation:

Utility locates and depth verification to identify existing underground utilities and relocation of unforeseen underground utilities not included in the project scope shall be paid from the allowance bid line item. Payment for utility relocation will be made from the allowance included in the bid.

### ➤ Contaminated Water & Soil Control:

SAWS will provide floodplain permit to the contractor. Contractor is advised to proceed with caution when working near these areas during rain events. Contractor is responsible for following all regulations and requirements associated with the testing, handling and disposal of contaminated soil and water as stated in the technical specifications as stated in the Technical Specification SS0804A. Reimbursement amount shall be the actual fees incurred associated with the project scope.

# Project Overview

## Special Conditions

### ➤ Bid Item - StandBy:

LS 310, 320, 326, & 329

When the secured facilities are under lockdown due to security requirements, Relocation of underground utilities. Contractor will not be allowed to perform construction activities near these facilities. Contractor shall include in the Price Proposal the costs associated with having to vacate the project site upon notice from SAWS, Port of SA, JBSA, or Boeing and leave equipment, materials, and tools in place.

### ➤ Bid Items – Intermediate Mobilization/Demobilization:

These item shall govern the intermediate mobilization/demobilization of personnel, equipment, and supplies at the project site associated with work on other contract items that will be performed by the Contractor.

# Project Overview

## Special Provisions to Specifications

### ➤ 100 & 101 Mobilization & Prep ROW

Measurement of the Item, Mobilization, as specified herein, shall be “Lump Sum” (LS) per Each Project Location as indicated in the plans as the Work progresses.

### ➤ 849 Sanitary Sewer Acceptance Testing

No direct payment shall be made for Air/Infiltration/Exfiltration, and Deflection Testing and all costs in connection therewith shall be included in the applicable contract price for the item to which work the pertains.

### ➤ 530 Barricades, signs & Traffic Handling

Unless itemized in the Bid Proposal Form, work performed shall be considered subsidiary to the pipe rehabilitation and/or Lift Station work.

### ➤ 540 Erosion & Sedimentation Control:

Work performed and materials furnished shall be considered subsidiary to pipe rehabilitation work and/or Lift Station work.

2019 Lift Station Elimination Near PortSA Project



# LS Site 105



## 2019 Lift Station Elimination Near PortSA Project





# LS Site 105

- Approx. 400 LF of 2-inch sewer line by OpenCut.
- One New LS
- Demolition of existing LS.
- Coordination with building occupants & CPS

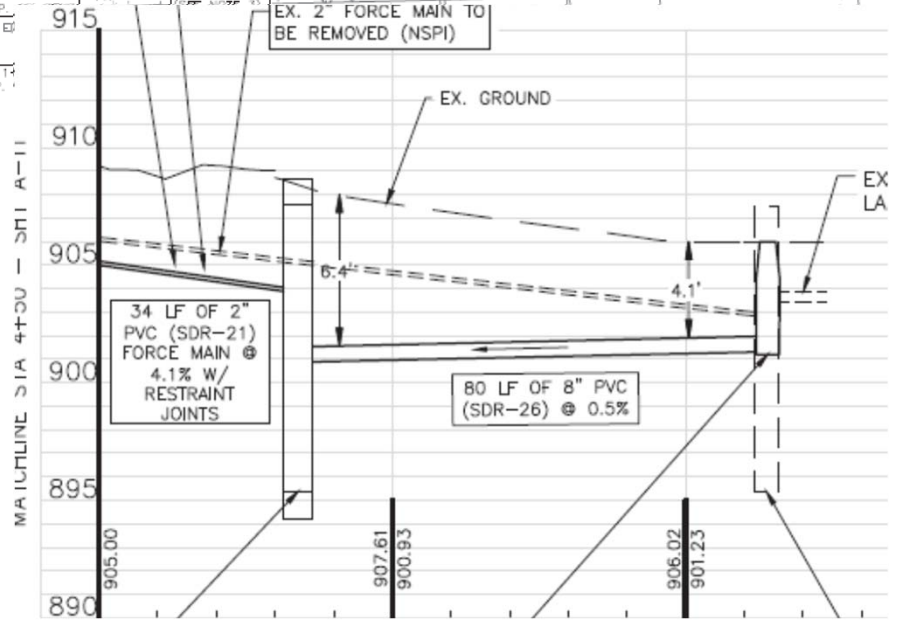
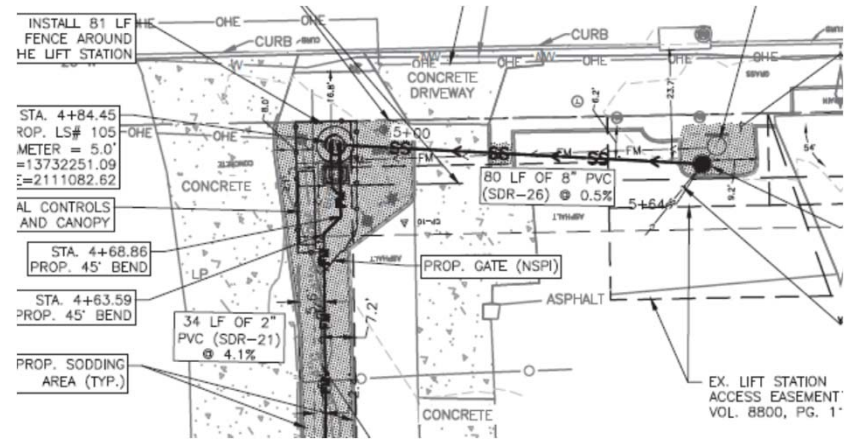
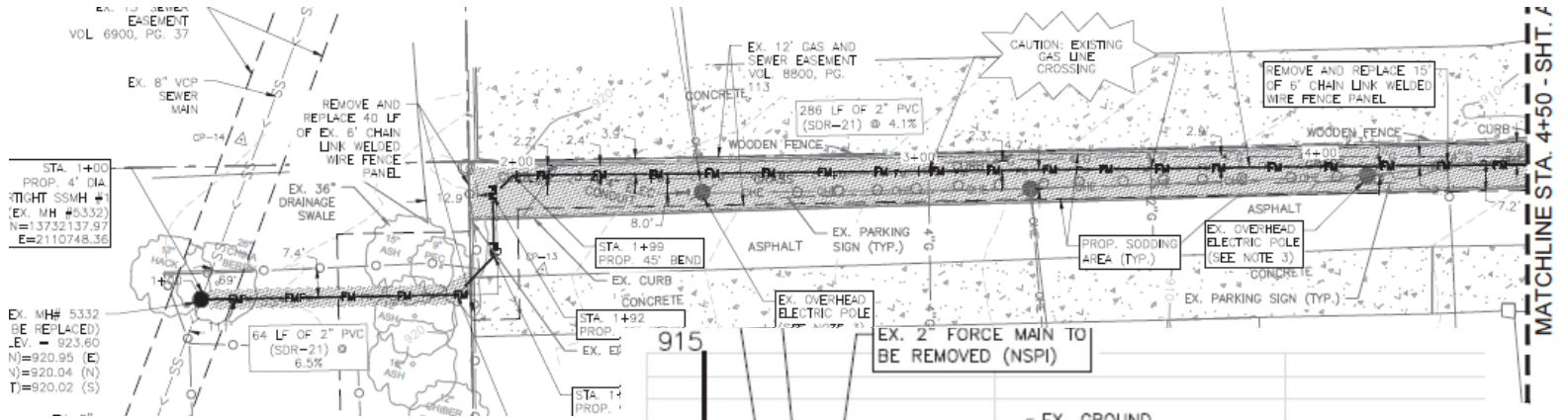

## 2019 Lift Station Elimination Near PortSA Project



# LS Site 260

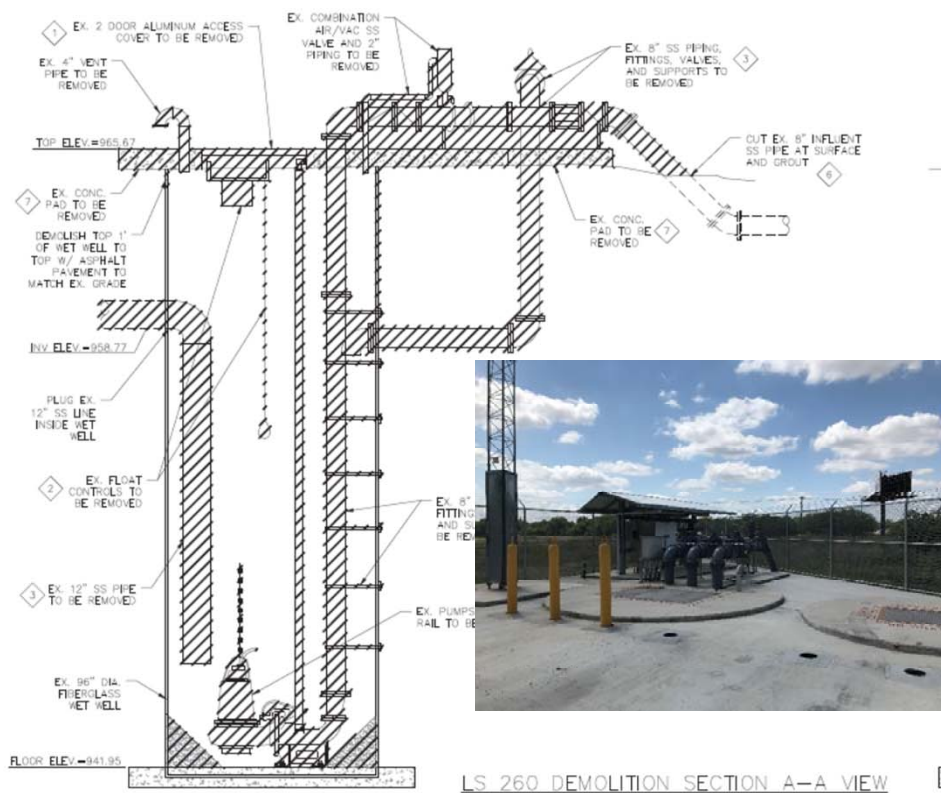

LS 260 DEMOLITION SECTION A-A VIEW  
SCALE 3/8" = 1'-0"



- Demolition of existing LS.
- EARZ area

## 2019 Lift Station Elimination Near PortSA Project



# LS Site 305

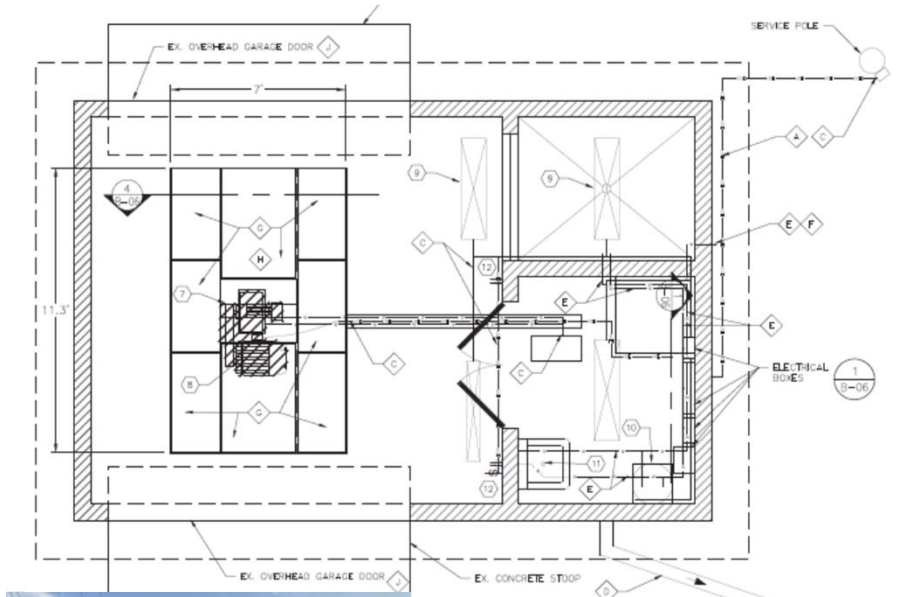

- Demolition of LS.
- Secured area
- Port of SA Permits
- Building remains in place.



EX. MH# 30530  
 TOP ELEV=688.87  
 6\" CIP (IN)=682.42  
 8\" VCP (IN)=682.42  
 8\" VCP (OUT)=682.42

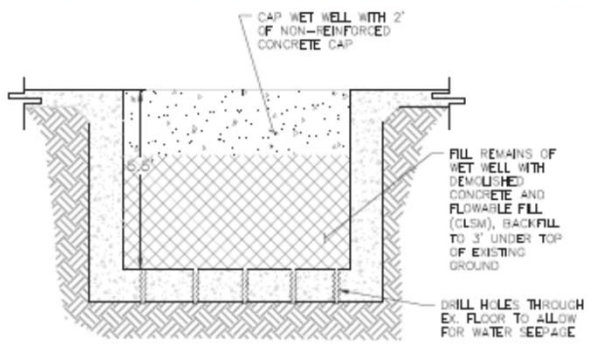

## 2019 Lift Station Elimination Near PortSA Project



# LS Site 307

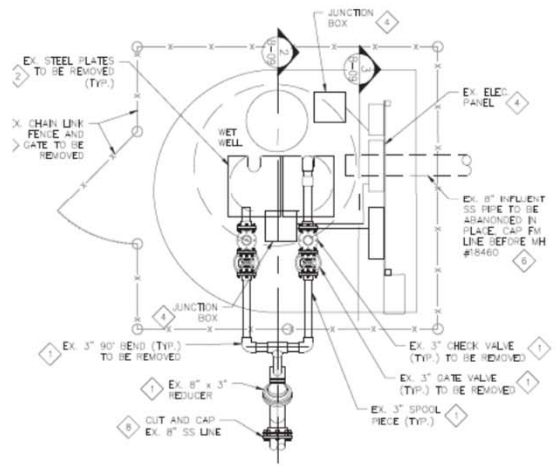
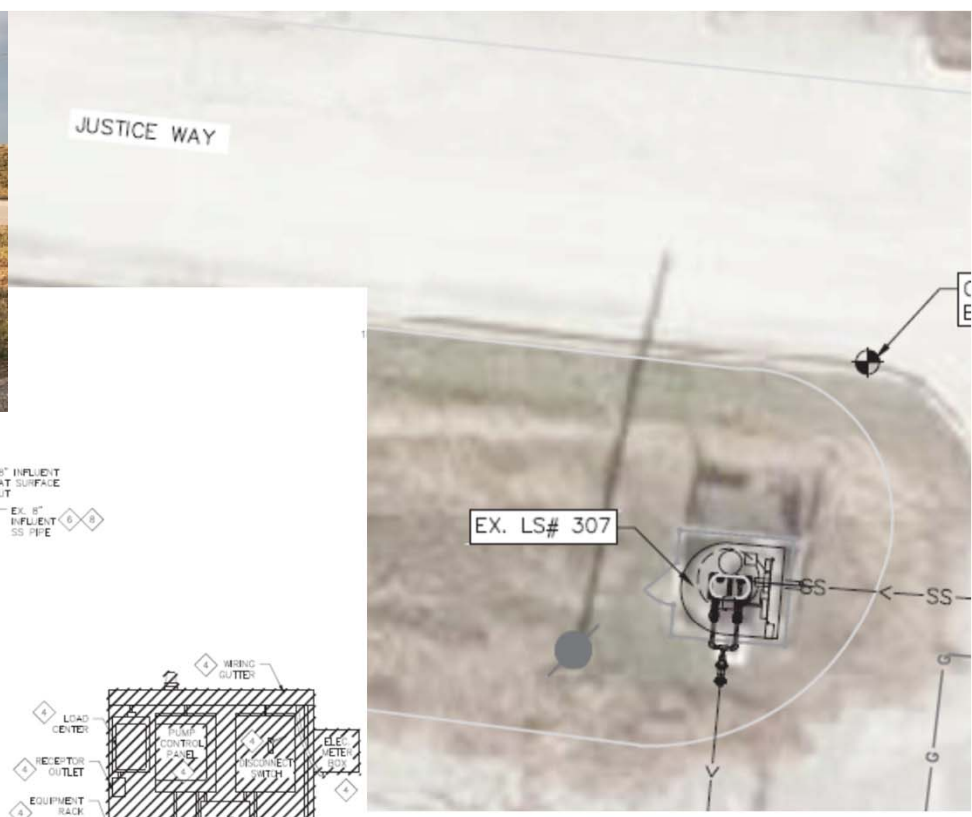

1 LS 307 – DECOMMISSIONING PLAN VIEW

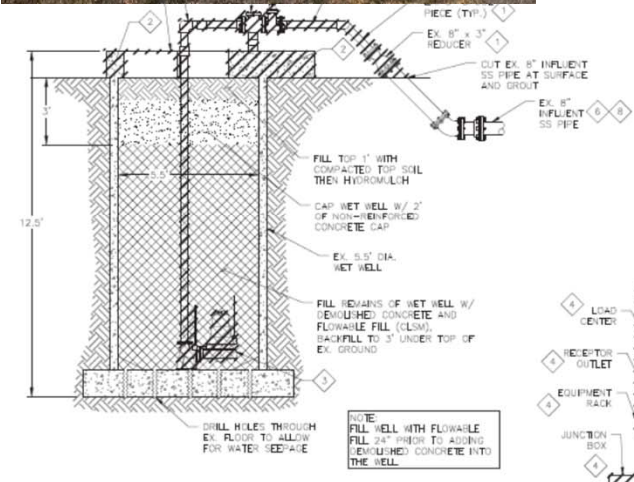

2 LS 307 WET WELL – SECTION VIEW

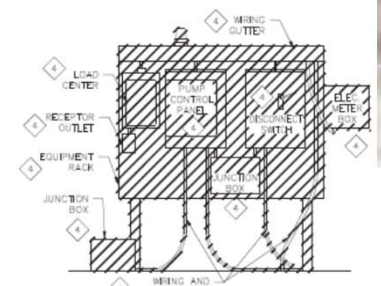

- Demolition of LS.
- Secured area
- Port of SA Permits

## 2019 Lift Station Elimination Near PortSA Project



# LS Site 329

- Demolition of LS.
- Secured area
- Port of SA Permits
- Lackland-JBSA Permit.
- Escort required

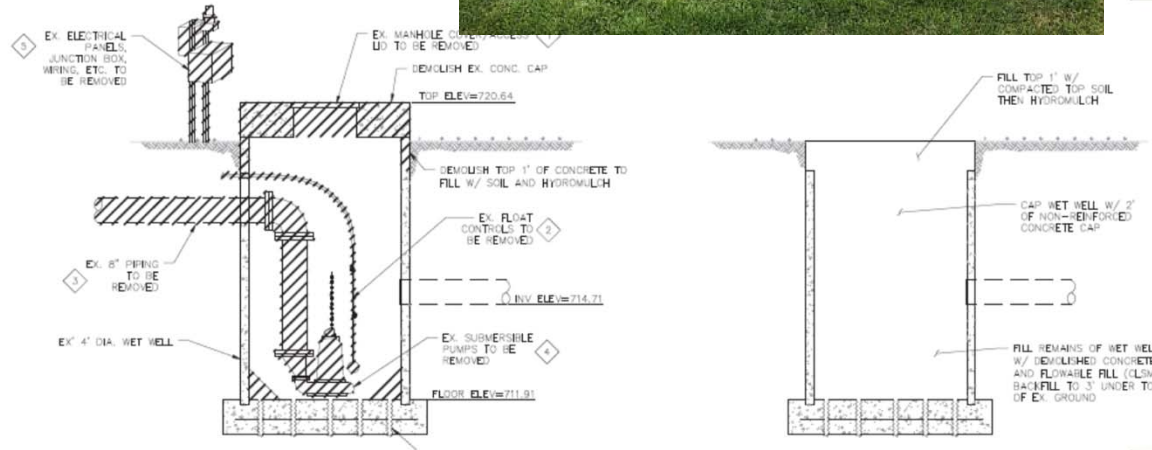

## 2019 Lift Station Elimination Near PortSA Project



# LS Site 333



- Demolition of LS.
- Secured area
- Port of SA Permits

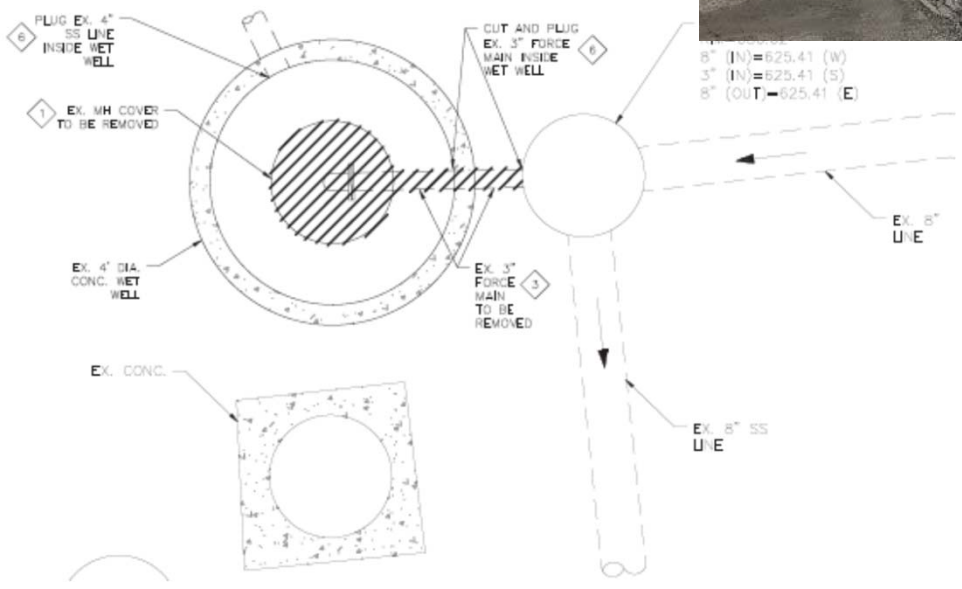

## 2019 Lift Station Elimination Near PortSA Project



# LS Site 310

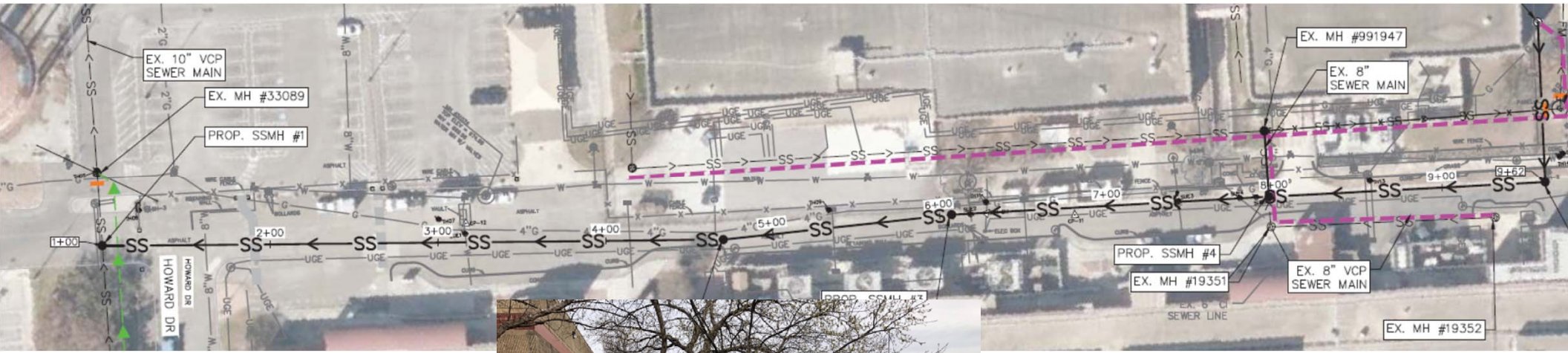

- Approx. 950 LF of 12-inch sewer line by OpenCut.
- Demolition of existing LS.
- Secured areas
- Port of SA permits
- WL adjustments

2019 Lift Station Elimination Near PortSA Project



# LS Site 310

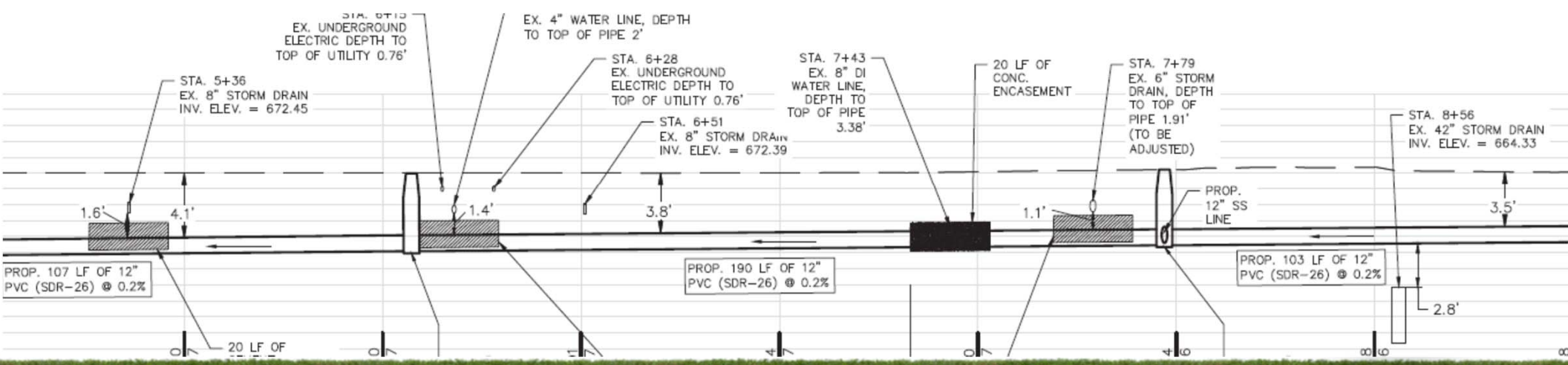
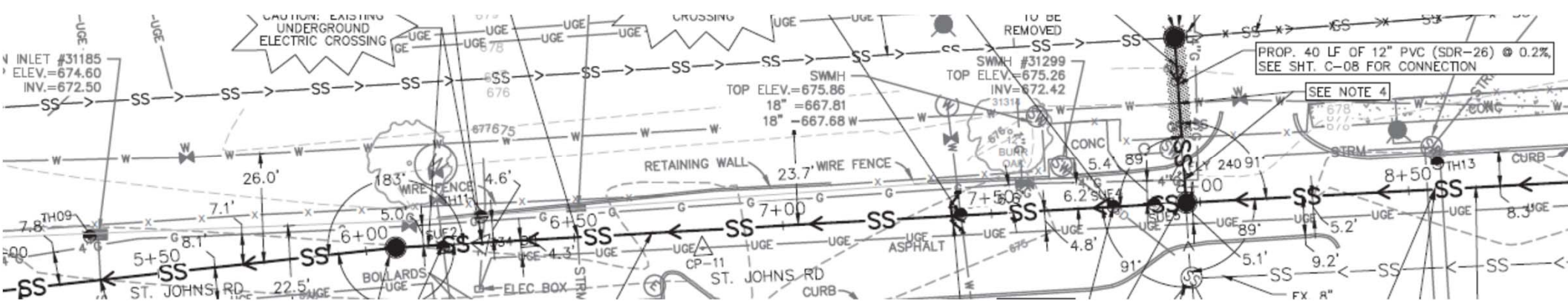

## 2019 Lift Station Elimination Near PortSA Project





# LS Site 320

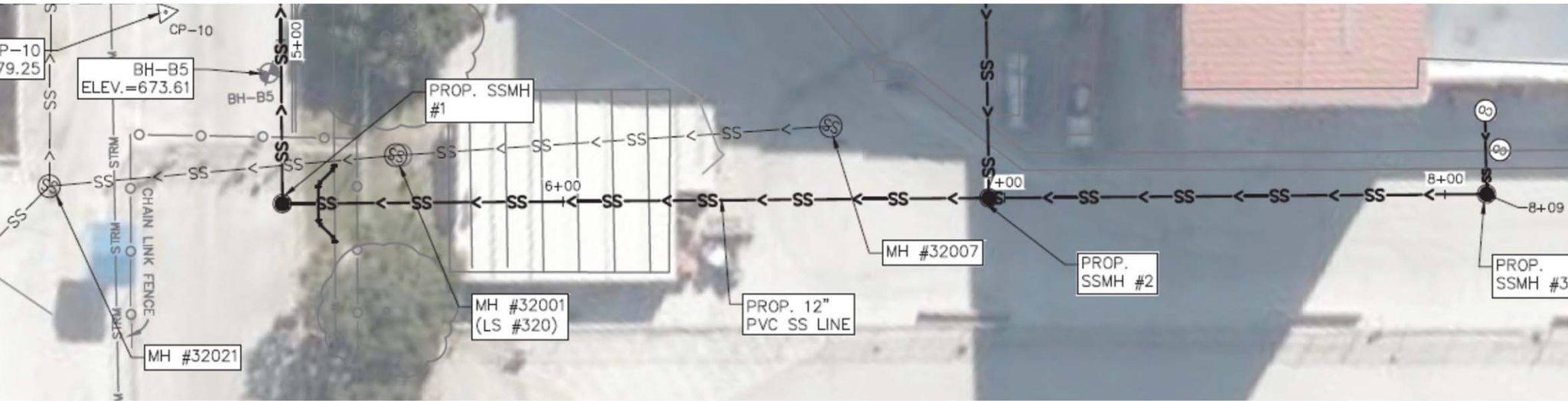
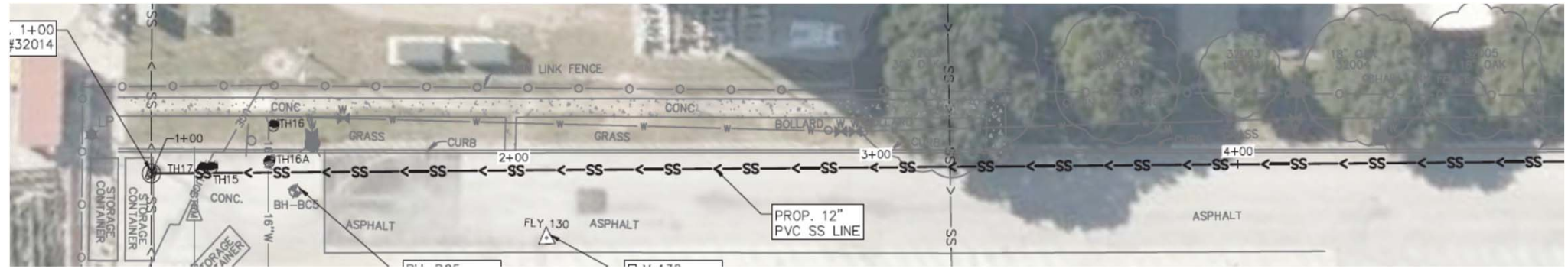

2019 Lift Station Elimination Near PortSA Project



# LS Site 320

- Approx. 700 LF of 12-inch sewer line by OpenCut.
- Demolition of existing LS.
- Secured areas
- Port of SA, Boeing, Standard Aero permits
- WL adjustments

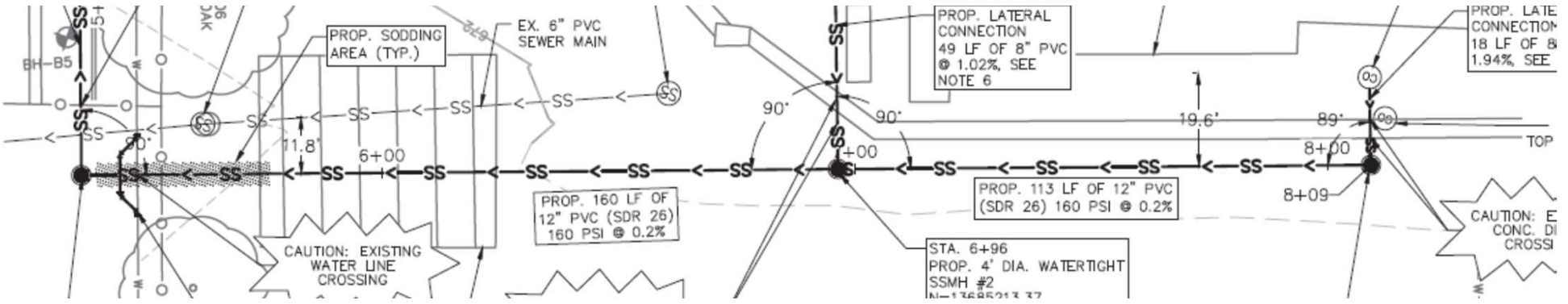
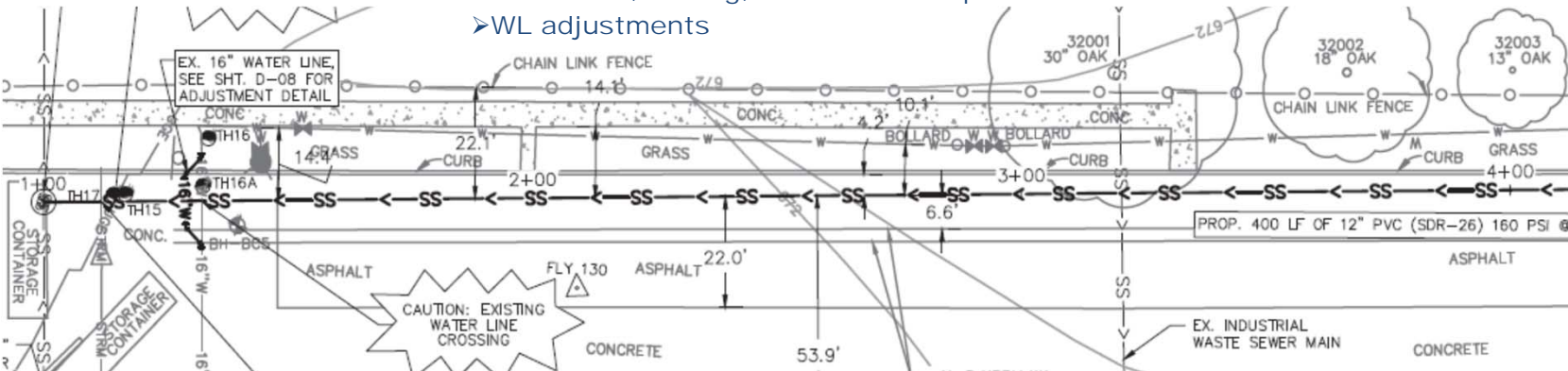

## 2019 Lift Station Elimination Near PortSA Project



# LS Site 326



## 2019 Lift Station Elimination Near PortSA Project



# LS Site 326

- Approx. 600 LF of 12-inch sewer line by OpenCut.
- Demolition of existing LS.
- Secured areas
- Port of SA, Boeing, Standard Aero permits
- WL & UGE adjustments

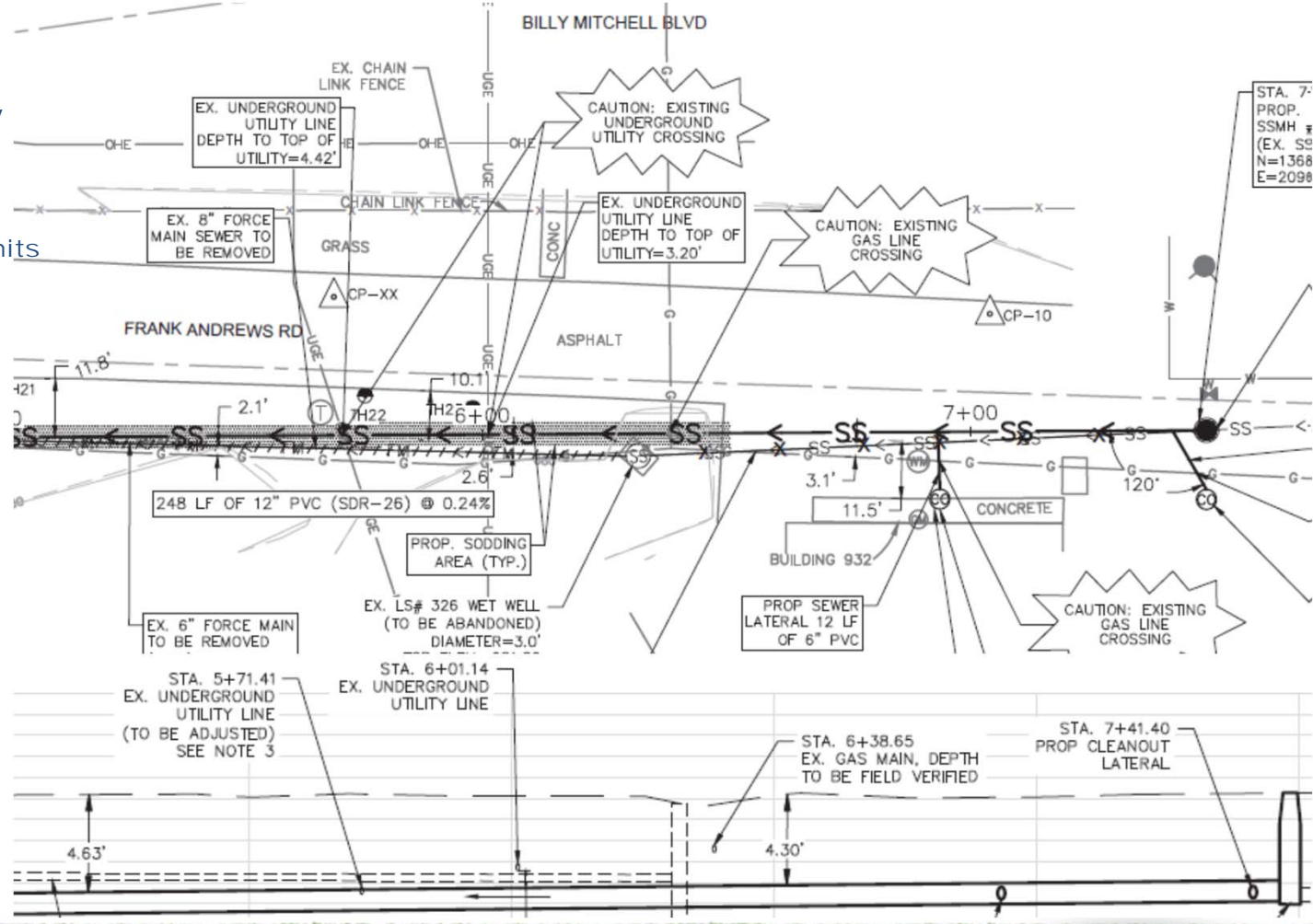

2019 Lift Station Elimination Near PortSA Project



# Technical Specifications

- SAWS Specifications for Water & Sanitary Sewer
  - Edition: Specifications Updated March 2020.
  - Link in Contract Documents.
- COSA Standard Specifications for Public Works Construction
  - Latest Edition. Link in Contract Documents.
- Special Specifications for LS 105

2019 Lift Station Elimination Near PortSA Project



# QUESTIONS?

*Reminder: Oral statements or discussion during the pre-bid meeting today will not be binding, nor will it change or affect the terms or conditions within the Plans and Specifications of this Project. Changes, if any, will be addressed in writing only via an Addendum.*

2019 Lift Station Elimination Near PortSA Project



# 2019 Lift Station Elimination Near PortSA Project, CO-00592

Orlando Cruz, P.E.  
Project Engineer, SAWS

Janie M. Powell  
Contract Administrator

Tracy M. Burns  
SMWVB Program Specialist

Reddy Kajuluri, PE, CFM  
Design Consultant

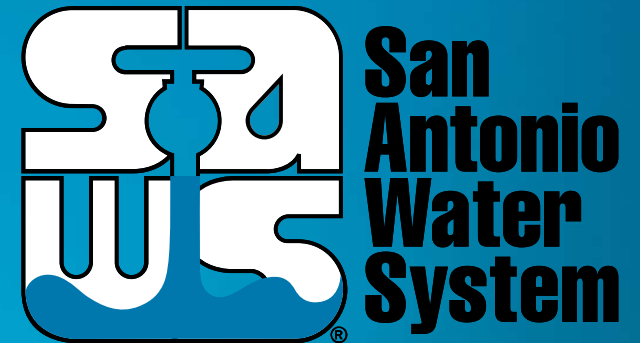

Non- Mandatory WebEx Pre-Bid Meeting  
September 6, 2022

MAKING SAN ANTONIO  
**WATERFUL**

